

057047/057048

ADJUSTABLE REAR FLOORBOARD KITS

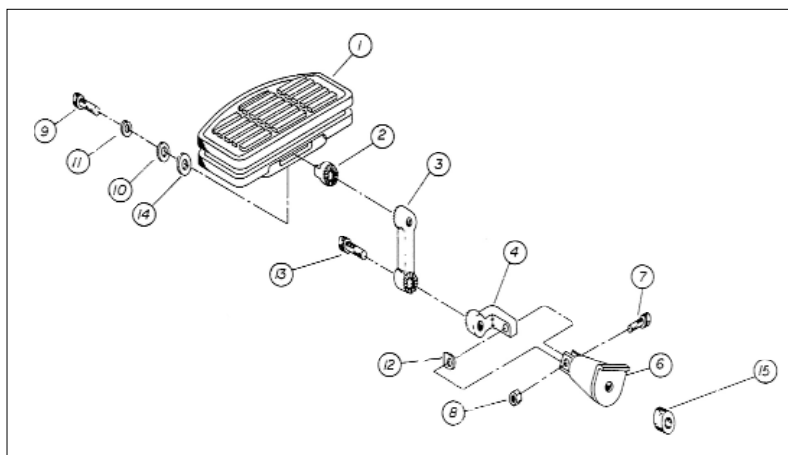

057047, FXR 1982-up, FLSTC 1990-up

Nr.	Qty.	Description
1	1	Mini Floorboard set
2	2	Slider star
3	2	Dog bone
4	1	Offset star (left)
5	1	Offset star (right) (not shown)
6	2	Mount FXR/FLST
7	2	3/8"-16 UNC x 1.50" long socket head screw
8	2	3/8"-16 Nylock nut
9	2	7/16"-20 UNF x 1.50" long socket head screw
10	2	7/16" flat washer
11	2	7/16" lock washer
12	2	Flat spring
13	2	7/16"-20 UNF x 1.00" long socket head screw
14	2	Floorboard washer
15	1	1/2" I.D. x 3/8" Hide spacer

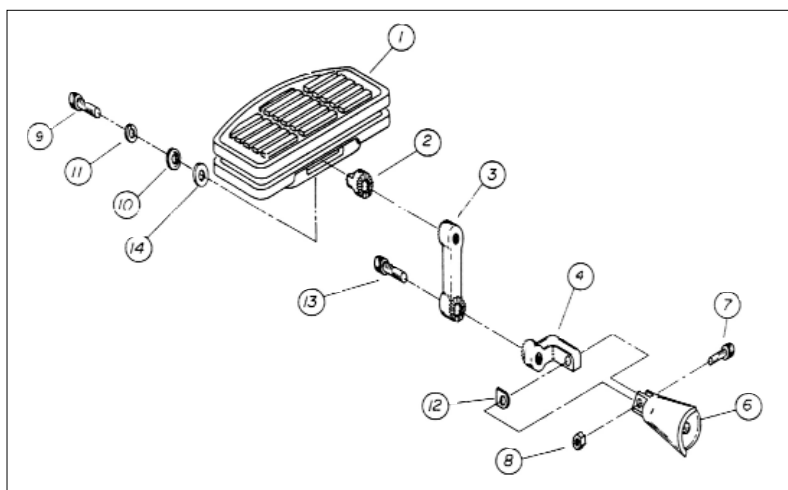

057048, FXST/FXSTC/FXSTS 1984-up FLST/FLSTC 1986 thru 1989

Nr.	Qty.	Description
1	1	Mini Floorboard set
2	2	Slider star
3	2	Dog bone
4	1	Offset star (left)
5	1	Offset star (right) (not shown)
6	2	Passenger mount FXST
7	2	3/8"-16 UNC x 1.50" long socket head screw
8	2	3/8"-16 Nylock nut
9	2	7/16"-20 UNF x 1.50" long socket head screw
10	2	7/16" flat washer
11	2	7/16" lock washer
12	2	Flat spring
13	2	7/16"-20 UNF x 1.00" long socket head screw
14	2	Floorboard washer

NOTE: Use blue Loctite on all hardware.

- Remove existing footpegs and peg mounts, retaining all hardware.
- For ZPN 057048, install passenger peg mount **6** to frame using original 1/2" bolt and lockwasher. Tighten securely.
- When installing ZPN 057047 on 1990-up FLSTC, using ZPN 233558 relocation kit, install brackets with spacers **15** between bracket and frame. Secure mounts and bracket using provided 1/2" bolt and lockwashers. Tighten securely.
- Install offset star mount **4** into female mount by placing spring **12** into clevis and pushing male star in as shown. Secure star mount using 7/16" bolt **7** and locknut **8**.
- Loosely install floorboard **1** to dog bone **3** using 7/16" bolt **9**, lock washer **11**, flat washer **10**, thick floorboard washer **14** and slider star **2** as shown.
- Install dog bone to offset star mount using 3/8" bolt **13**, position dog bone as desired and tighten securely.

NOTE: All intended floorboard locations must be checked for ground and accessorie clearances. ZODIAC strongly recommends a minimum 9 ground clearance for all possible cornering angles.

- Rotate floorboard to desired position and tighten securely.
- Re-check all hardware and clearances before test driving motorcycle.